

2 BED | 1 BATH

INDOOR LIVING: 629 - 669 SQ. FT.  
 OUTDOOR LIVING: 54 - 178 SQ. FT.  
 TOTAL: 683 - 847 SQ. FT.

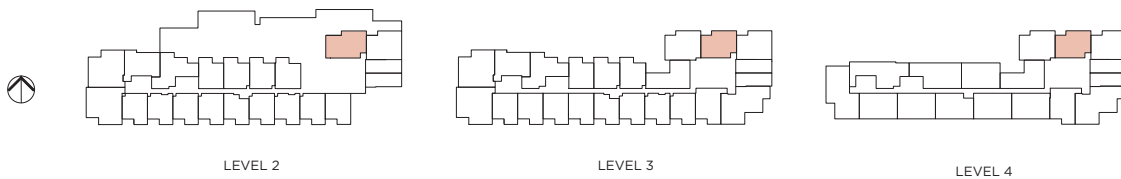

Dimensions, sizes, specifications, plan orientation and materials are approximate only. All patio, terrace and balcony sizes may vary. Windows, columns, privacy screens, demising walls, spandrel and guardrail details may vary from home to home. The quality of homes at Sydney are built by LM Sydney Homes Limited Partnership. E & O.E.